







**LEGEND - PROPOSED**

-  = CATCH BASIN
-  = STORM MAN HOLE
-  = SANITARY MAN HOLE
-  = TYPE A RIPRAP APRON
-  = SPOT GRADE
-  = CONTOUR
-  = CONCRETE OUTLET STRUCTURE
-  = STORMTECH SC-740 SYSTEM

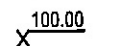
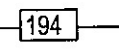

NOTE:  
CONFIRM FINAL BUILDING FIRST FLOOR ELEVATION WITH FINAL ARCHITECTURAL FLOOR PLANS

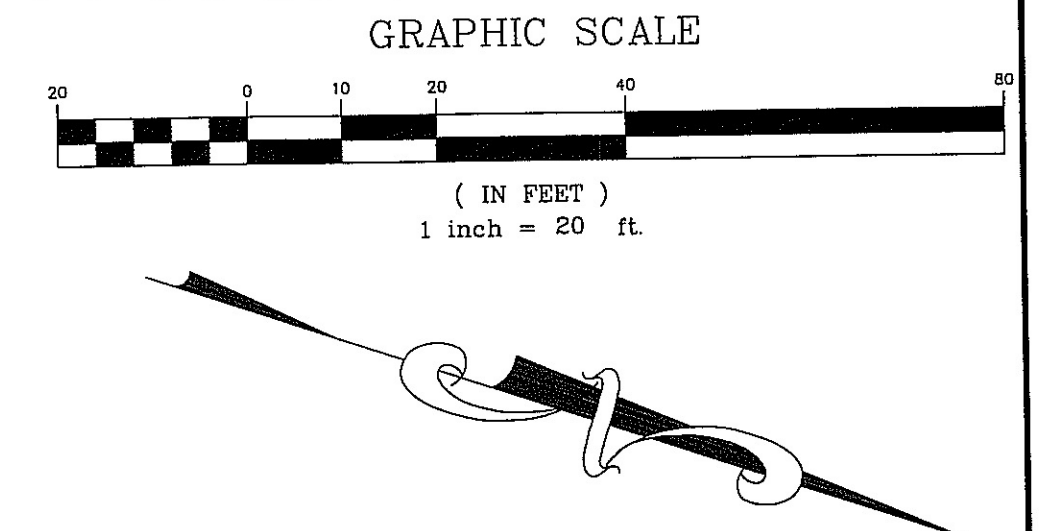
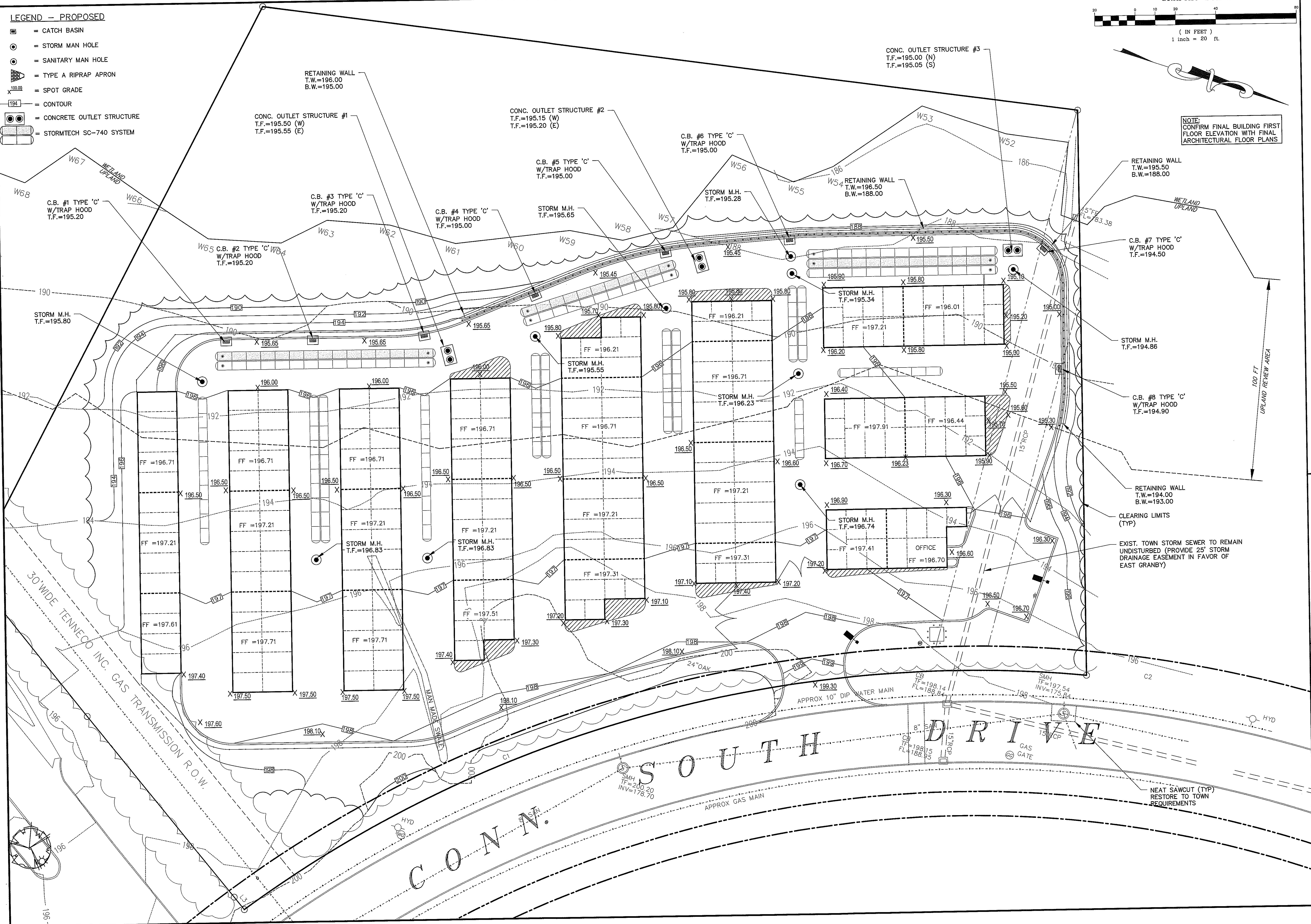

Revisions:

No.	Date	Description
1.	12-23-2022	Town Comments

GRADING PLAN  
 PREPARED FOR  
**SWEAT EQUITY, LLC**  
 10 CONNECTICUT SOUTH DRIVE  
 EAST GRANBY, CONNECTICUT  
 Date: 10-21-2022 Drawn by: ERN Job no.: 22095  
 Scale: 1" = 20' Checked by: DSZ Sheet no.: 1 OF 1  
 C:\2022\22095 - Connecticut South Drive\Submittal\2022-12-23\GIS\GR-1, 2022-12-23.dwg, GR-1, Dec. 21, 2022 - 7:28:35 AM

**GR-1**

**F. A. Hesketh & Associates, Inc.**  
 3 Creamery Brook, East Granby, CT 06026  
 Phone (860) 653-8000 Fax (860) 844-8600  
 www.fahsketh.com - malighsketh.com  
 Civil & Traffic Engineers - Surveyors - Planners - Landscape Architects

